

UTYL 2 Lighting points 8 m
LED 88 W - 7 405 lm + 45 W - 3 432 lm*

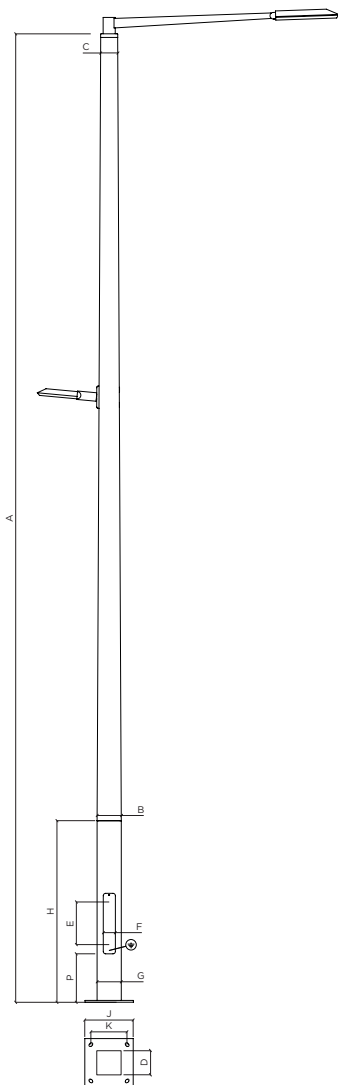

			Square tapered	Round tapered
UTYL 2 LED 88 W + 45 W*			PCS9802	PCD9802
A	m	Pole height	8	8
B	mm	Shaft section/diameter at base	200	194
C	mm	Shaft section/diameter on top	140	140
D	mm	Door: useful depth	175	148
E x F	mm	Door: useful height x width	500 x 100	450 x 100
P	m	Distance door bottom to plate	0.4	0.35
G	mm	Base section/diameter	200	194
H	m	Base height	1.5	1.2
J	mm	Base plate dimensions	400 x 400	400 x 400
K	mm	Spacing dimensions	300 x 300	300 x 300
L	mm	Anchor rods**	4 HA20 M18 - 400	4 HA20 M18 - 400
	kg	Weight	157.5	124.6
	m	Height of the light	8.12	8.12
	m	Height of offset light	5	5
	m	Offset reach of bracket to axis	1.9	1.9

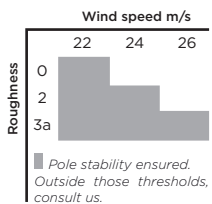

WOODEN SUPPORT

Glued laminated timber GL24H shaft certified ACERBOIS GLULAM, produced with sawn planks from sustainably managed forests and respecting HTE process. Timber finished with four coats of woodstain.

Flush base in galvanized steel and polyester powder coated finish. Overlying top in pressed galvanized steel, polyester powder coated finish. Design and manufacture according to rules defined by DEE 120017-00-0106 Wood and metal lighting columns and specifications from European Technical Approval ETA-18/0016.

CE marked product: Conformity certificate CE 0679-CPR-0473.



SQUARE TAPERED SUPPORT

Degressive square column
Square base

ROUND TAPERED SUPPORT

Round tapered column
Round base



STANDARD COLOUR IDENTITY

Wood: Brume - Metal: Black 100 sanded.

Cpa Car parking area - Pr Public road - Ap Access path - Cp Cycle path - Pf Pedestrian footpath - S Street



TOP: LED LIGHT 88 W*

See features of 88 W LED lighting points page 120.



OFFSET LIGHT: LED LIGHT 45 W*

Asymmetrical elliptical lighting.



3 432 lm - Colour temperature 4 000 K (T° 3 000 K as option).

Colour rendering index R_a > 80.

Cast aluminium, aluminium and stainless steel.

Safety glass, antireflection-coated. Reflector in pure anodized aluminium.

Dust-proof and water jet protected.

Adjustable joint for beam direction 0° or 15°.

Delivered with connecting cable X05BQ-F 4 x 1² - Length 10 m.

Power supply LED 220-240 V - 0/50-60 Hz.

DC 176-264 V - Dimmable 1-10 V.

Class II - IP 66 - IK 08 - Weight: 5 kg.

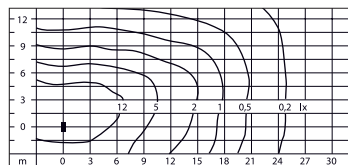
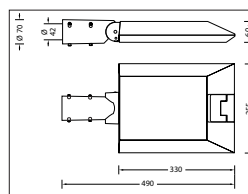

Light distribution LED 45 W.

NOTES

Luminaires delivered without case, light head not assembled on the shaft.

The lighting fixture must be connected to the earth of the base section thanks to the green/yellow wire provided for that purpose.

*Power and luminous flux data likely to vary.

**Anchor rods supplied on request only.